

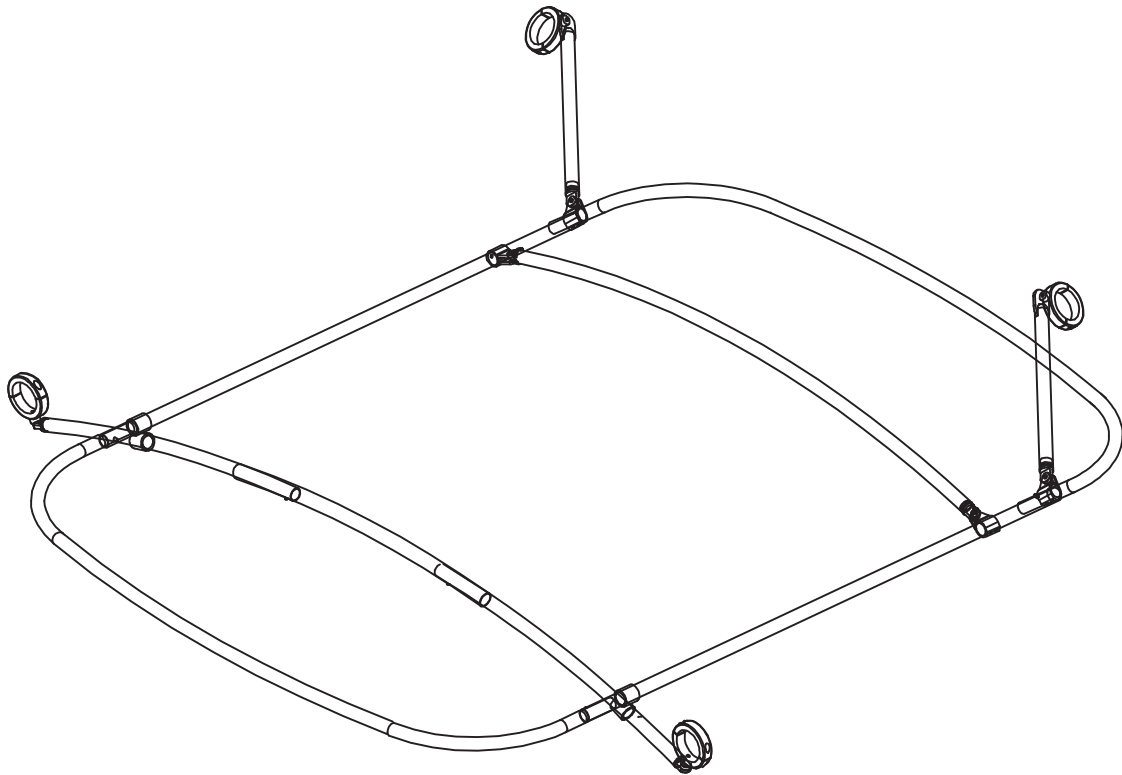

INDY WAKEBOARD TOWER BIMINI TOP



INSTALLATION GUIDE

EXPLODED VIEW OF THE INDY WAKEBORD TOWER BIMINI TOP

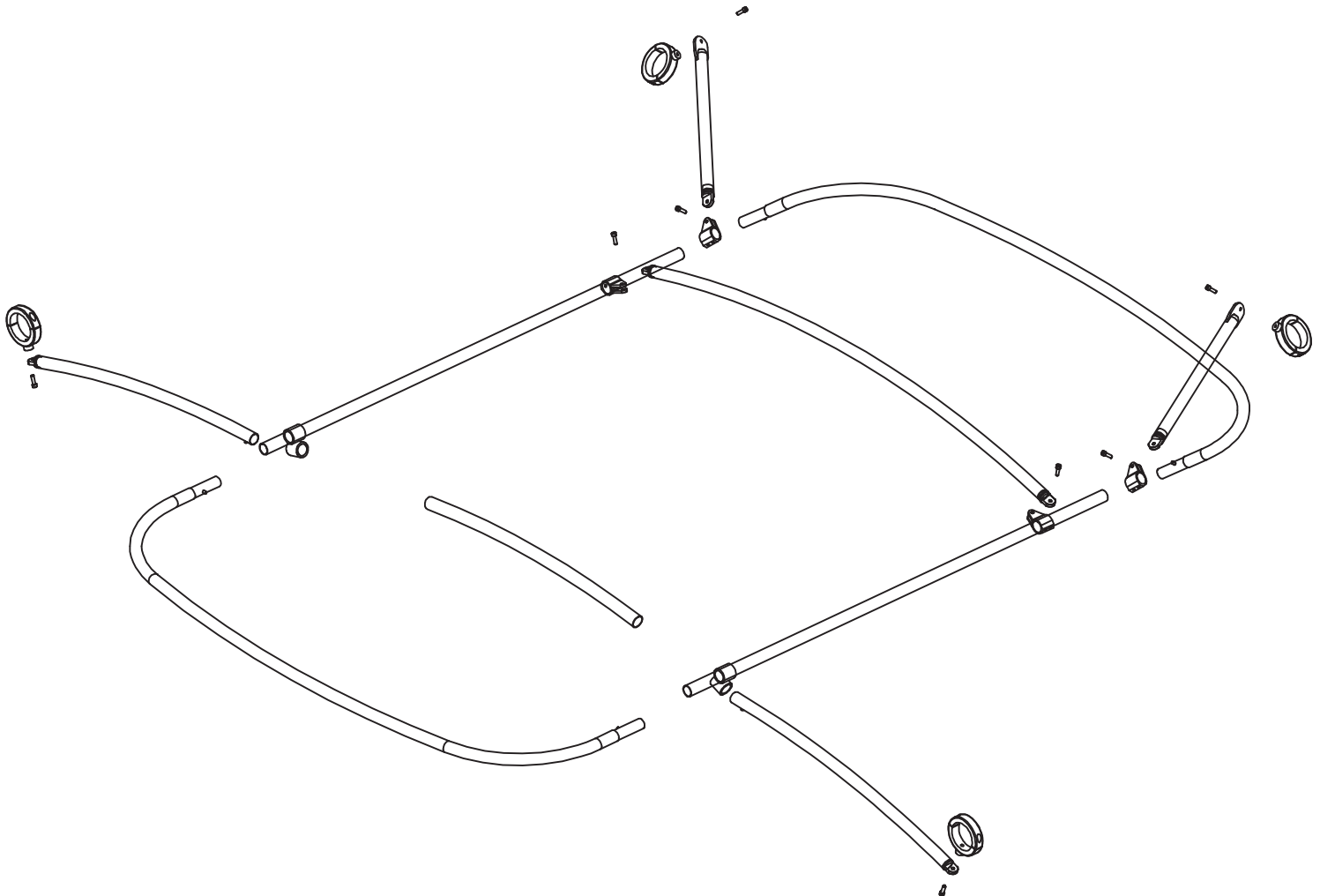

STEP 1:

Unpack and check the contents of the box

Check the parts list and the Instruction Guide correspond with the product you purchased

Ensure you have the correct tools to complete the Installation.

Ensure you have the skills to complete the installation.

Please Read all Instrustion prior to installation

If you are NOT sure of any part of the guide or you have any questions

Please contact the supplier or Indy Wakeboard Towers

Email: indywakeboardtowers@gmail.com

www.indywakeboardtowers.com

INSTALLATION GUIDE

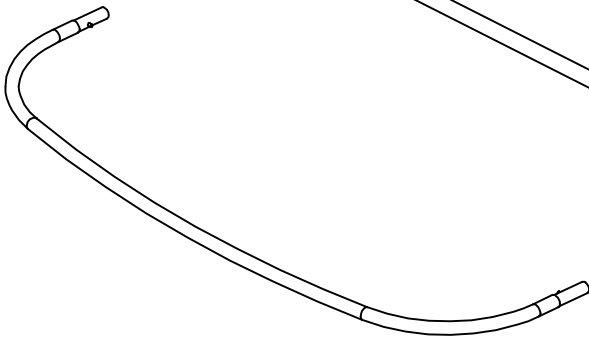

2 x Bent bars, front and Rear frame

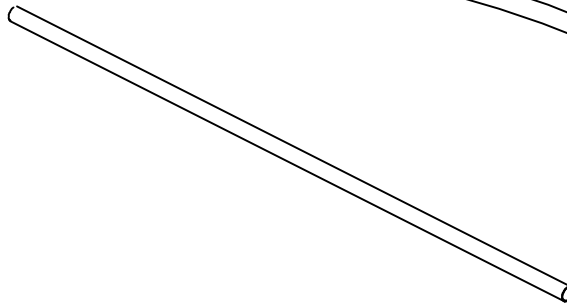

2 x Long straight side bars
for frame

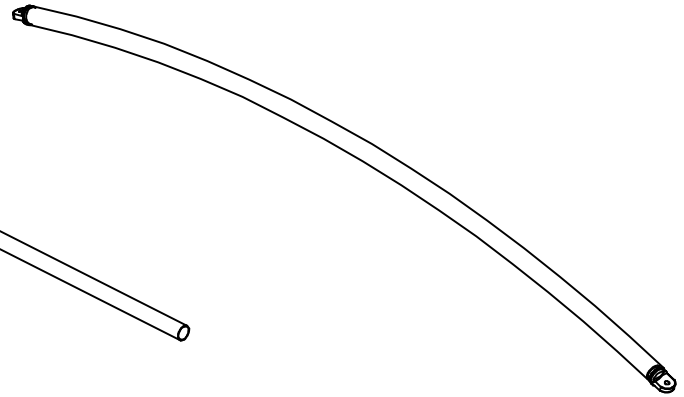

1 x Long curve beam

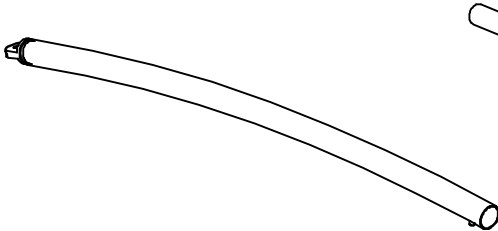

2 x Curved tubes with Pin and
rotating fitting

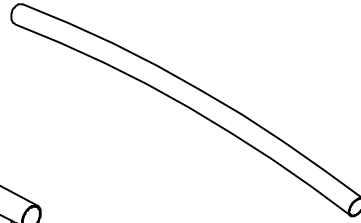

1 x short curved bar with
drilled Holes

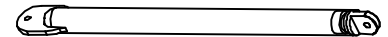

2 x Support arms fix and rotating
end fitting.

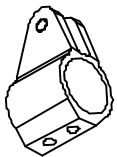

4 x Aluminium Clamps



2 x Double X tube fittings



4 x Aluminium Clamps

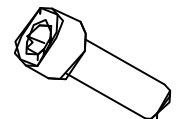

8 x M6 Bolts

1 x Black Sunbrella Material cover with zipper and velcro tabs.

INSTALLATION GUIDE

STEP 2: BUILD THE OUTER FRAME OF THE FLAT BIMINI TOP

NOTE: The two x curved front and rear of the frame are the same shape. Please note the curve, bend when lying flat on the ground. The curve is to go to the top of the Bimini. Ensure both are facing up.

NOTE: The long side bars of the frame have a Indy Logo attached. When you attach the frame together using the pin system ensure the logo is facing up and can be read when the curved ends are attached.

Use the Pin system to attach the outer frame together to make the shape of the bimini top.

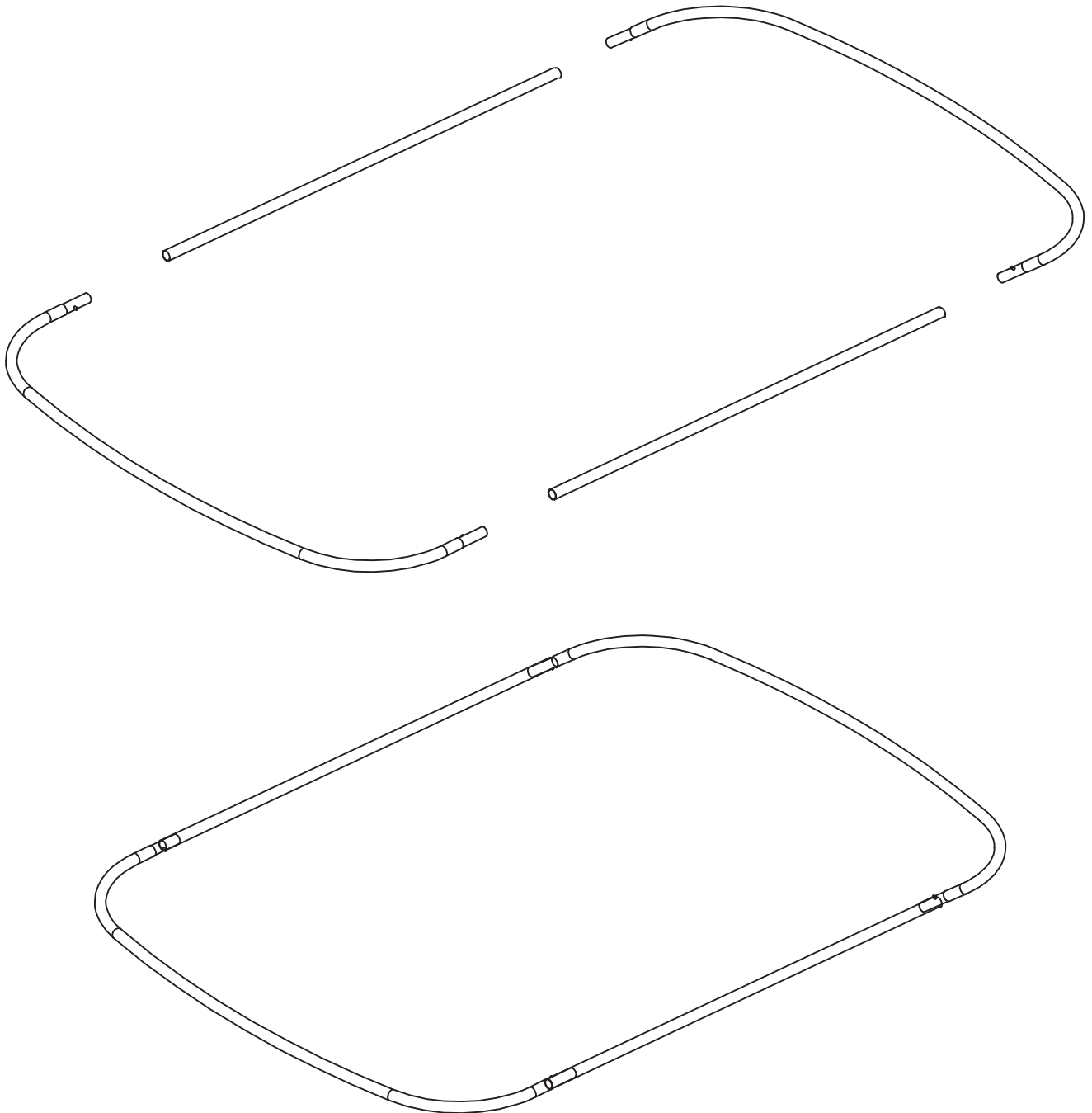

INSTALLATION GUIDE

STEP 2: ATTACH THE MAIN ADJUSTABLE 3 PIECE BEAM

(A) Detach one end of the main frame and insert the double tube fitting onto the frame. you can lock the fitting into a position near the join using the small grub screw (leave so you can adjust angle slightly) Repeat on opposite side.

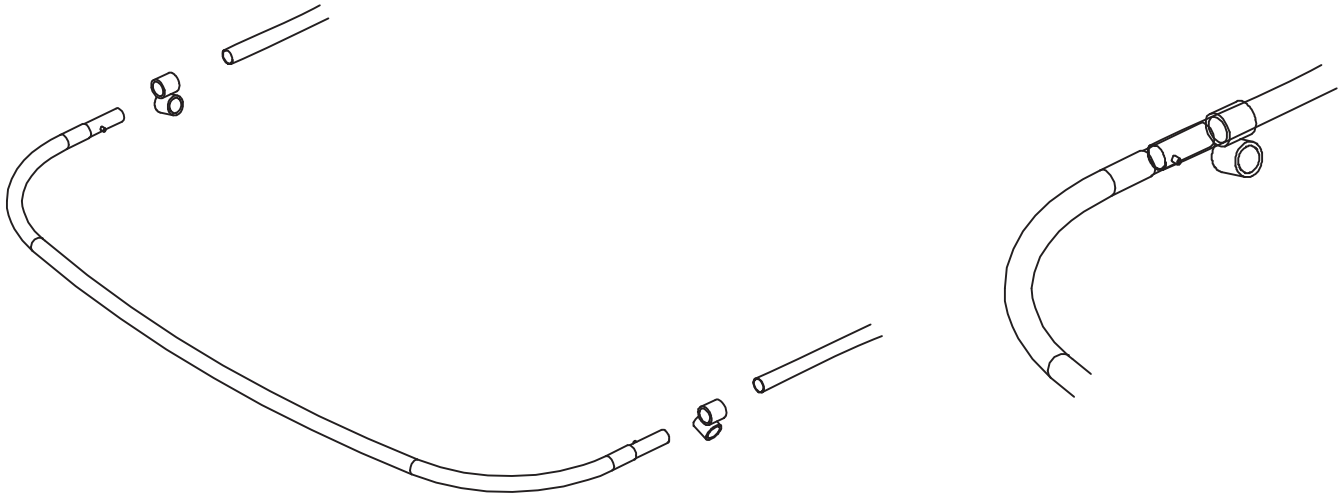

(B) Attach the 3 piece adjustable main beam to the outer frame. Insert one end bar which has the rotating end through the double fitting. The rotating fitting faces outwards. Insert the pin section in the middle curved bar with the pre drilled hole settings. Repeat the process for the opposite side.

NOTE: You can adjust the main beam to suit the distance between your tower legs.

NOTE: You can also adjust the double fittings by sliding forwards and backwards to change the position of the tower bimini. For now do approx measurements and lock into position.

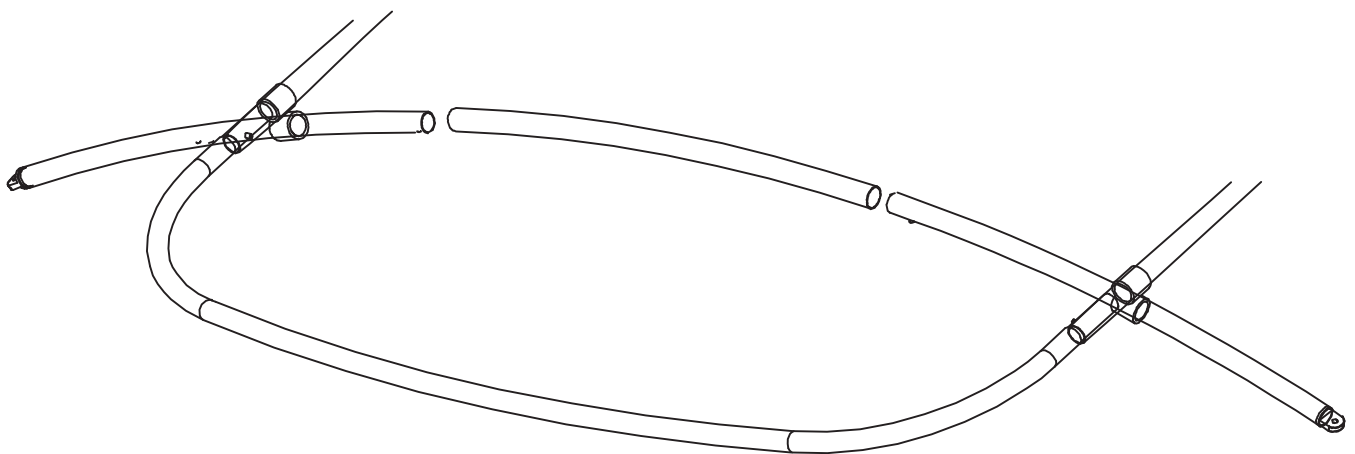

INSTALLATION GUIDE

STEP 3: Attach the second single cross beam to rear of the outer frame

Remove the rear curved outer frame by releasing the pins. Now you can slide on the attachment fitting to each straight section of the frame. Then you can re attached the curved end frame.

Now you can attach the long curve beam between the two fittings.

NOTE: The curve beam faces upwards the same as the curved end bars.

NOTE: The two fittings can slide forwards and backwards for adjustment.

lock in position you require to hold the canvas nice and tight. (can be done later)

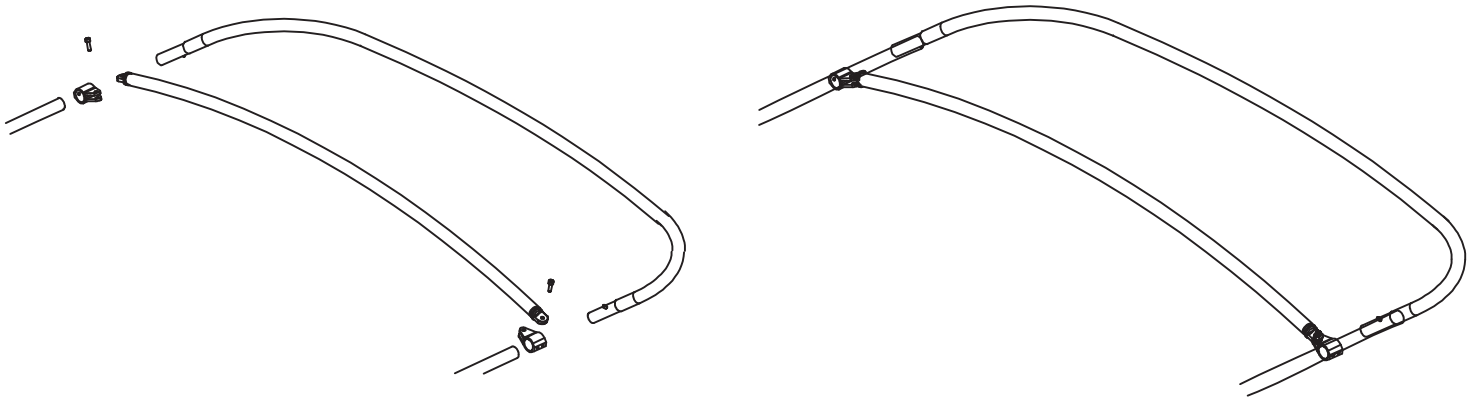

STEP 4: Attaching the rear support arms

Remove the rear curved outer frame by releasing the pins. Now you can slide on the fittings one to each side and spin them to face upwards. use the grub screws to slightly tighten them.

Now you can attach the support arms to the fittings.

NOTE: The support arms has one rotating end this is used for adjustment for different angles of the support arm.

NOTE: You can slide the fitting on the frame forwards, backwards and if require for your tower you can spin to face downwards.

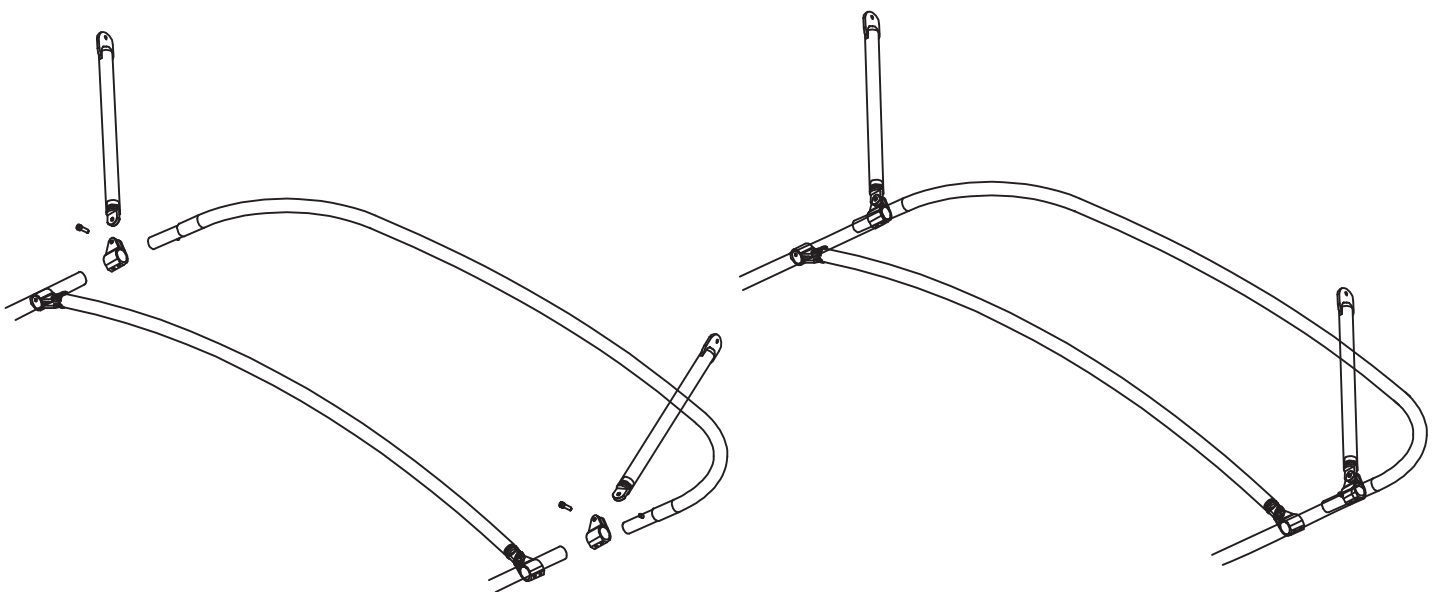

INSTALLATION GUIDE

STEP 5: ATTACHING THE INDY BIMINI TOP FRAME TO WAKEBOARD TOWER

Now you have you frame connected together and support arms attached facing upwards if you are going to attach the bimini top to the underside of the tow point of the tower frame.

(a) Now stand in you boat and mark the wakeboard tower legs at the front where you would like the bimini top height to be. Measure and install clamps at the same height on both front legs. Face the clamp with the threaded section up towards the front of the boat.

(b) Now you can measure between the two threaded postion on each clamp across you front legs. Take this measurement. Now go to your frame and adjust the main pin beam. Measuring between the ends with the small rotating end fittings.

Note: You might have to move the camps up, down or swing in or out for minor adjustment.

(c) With and extra person or two place the frame and main beam in position and attach to the clamps. NOTE the bimini will pivot on the rotating end fittings.

(d) Now you can Install the rear clamps to your tower. For and INDY Pro tower you can place them on the anywhere on the top section bars.

NOTE it is best to move the support arms around to find the best looking postion on the tower. check out the website for some ideas of where to attach to the INDY tower.

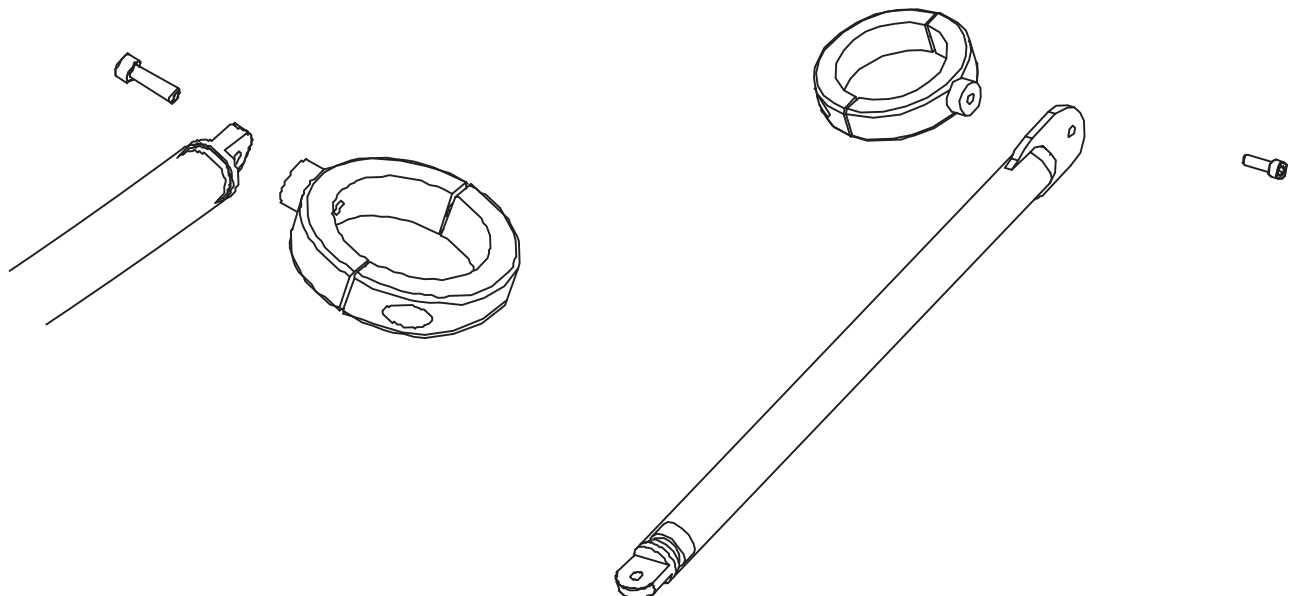

INSTALLATION GUIDE

STEP 6. Attaching the Bimini Top Sunbrella Cover.

Lay out the Sunbrella material cover.

NOTE: One end of the cover has a full sewn in pocket with a zipper across from side to side. This part you place over the front curve bar of the frame. Now you can slide over the top of the frame the rest of the cover and using the zippers and and velcro tabs you can tighten the material cover.

NOTE: ensure the curves in all the bars from side to side face upwards.

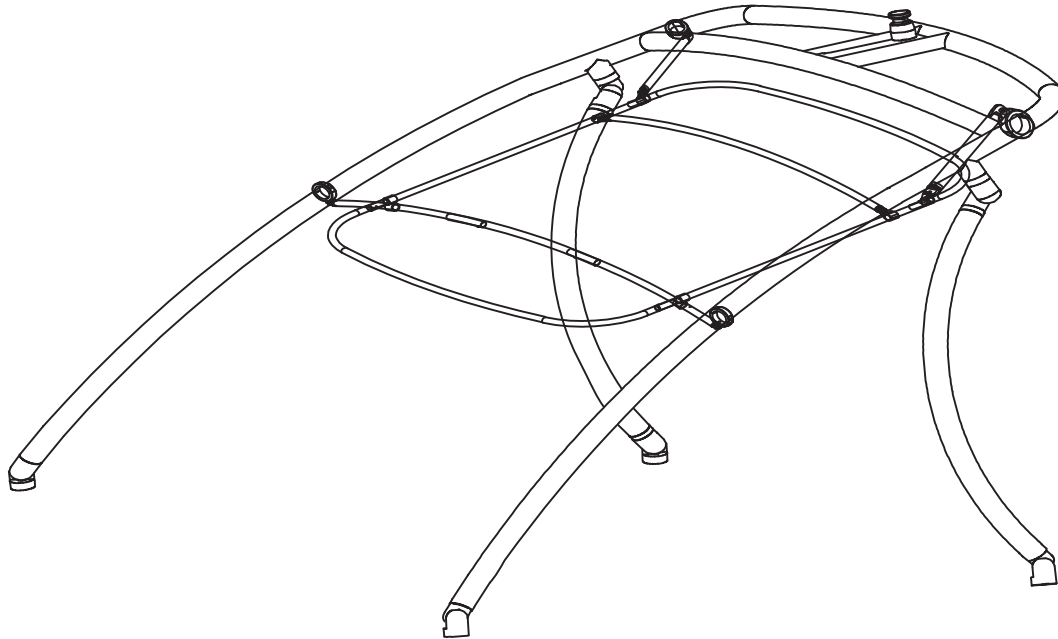

STEP 7. If you wish to place the bimini top above you tow point of your tower you will need to do some adjustment and add in two more T frame pieces from your kit.

(a) This time the main adjustment frame will be to the rear. You need to now place the T section fittings over main adjustable bar by removing the side curved bar and then slide the T section over it and re pin into the smallest position. Do this to both side of the main beam.

(b) Now the rear clamps will be positioned on you top bar, either side of you tow point as far as possible to the side of you towers top section.

(c) The support arms will face down wards and will clamp to your front legs.

(d) With a couple of extra people hold the bimini top above the tow point and attach the T sections to your clamps on the top bar. You will have to do minor adjustments of the clamp and to T sections to create the correct angle of the bimini and clamps and T sections.

(e) The front support arms you can attach to the clamps positioned on the front legs. You will have to adjust the clamps up and down the legs to suit your tower. You can also move the frame forwards and backs by adjusting the fittings on the side bars of the frame.

INSTALLATION GUIDE

CARE AND MAINTENANCE

Be sure to check and tighten all fasteners and connections prior to every use
When towing behind your vehicle remove the material cover via zippers and velcro
This will protect your bimini from damage whilst travelling and also great for cleaning and storage.
Use soap and water to clean your bimini top frame.
Always rinse and wipe down the frame.
The material is 304 stainless steel you will need to clean and polish the tubes and fittings
to ensure not surface rust appears. If left unattended surface rust will appear.
You can spray a marine clear application over your fittings to help protect them from the environment
Also lock tight your small grub screws and screws.

WARRANTY

Indy warrants the product (not including other 3rd party accessories) against manufactures defects.

To claim you must contact Indy or is Distributor. The product/part is to be sent to the Distributor
for inspection where it will either be repaired or replaced. (unless otherwise agreed in writing)
The customer is liable for costs associated in shipping the product/part to Indy.

Indy is not responsible for personal injury or damage to the boat caused by the use of the product
or any transport charges or cost of installation or removal of the product. Indy is not liability for direct
or indirect or consequential damages resulting from delay or improper installation.

Warranty does not cover anodised, polished, powder coated surfaces as well as any hardware
corrosion, rust, they are specifically excluded as their care and use can not be controlled by Indy.

For the genuine Sungbrella material see their website for instructions for cleaning and care of the
material.

Indy Wakeboard Towers
www.indywakeboardtowers.com

INSTALLATION GUIDE